

LOGAN CITY COUNCIL  
APPROVED PLAN OF DEVELOPMENT  
This is the approved plan of development for Development Application  
OW/42/2018

# LEGEND

- NOMINAL FACE OF KERB LINE
- STAGE BOUNDARY

# NOTES:

1. WALL ALIGNMENT IS TO BE PEGGED FOR INSPECTION BY SUPERINTENDENT PRIOR TO CONSTRUCTION.
2. WALLS TO BE VERTICAL FACE TYPE TO A MAXIMUM HEIGHT OF 1.5m. TYPE, FINISH AND COLOUR TO BE APPROVED BY SUPERINTENDENT.
3. CONTRACTOR IS RESPONSIBLE FOR PROVIDING STRUCTURAL DESIGN, CONSTRUCTION SUPERVISION AND STRUCTURAL CERTIFICATION BY A SUITABLY QUALIFIED AND EXPERIENCED REGISTERED STRUCTURAL ENGINEER (RPEO) FOR ALL WALLS 1.0m HIGH OR GREATER.
4. WALL TO BE DESIGNED FOR A MINIMUM SERVICE LIFE OF 50 YEARS.
5. THE STANDARD BUILDING REGULATION 1993 REQUIRES THAT A BUILDING APPLICATION BE LODGED FOR EARTH RETAINING STRUCTURES > 1000mm HIGH.
6. ALL WALLS TO BE DESIGNED BASED ON A GEOTECHNICAL ASSESSMENT OF INSITU SOILS BY A SUITABLY QUALIFIED ENGINEER.
7. ALL CORNER RETAINING WALLS TO BE CONSTRUCTED IN A ROAD RESERVE WHERE POSSIBLE.
8. PRIVATE WALLS INCLUDING FOOTING TO BE CONTAINED WHOLLY WITHIN PRIVATE PROPERTY AND ARE TO BE FULLY CONTAINED WITHIN THE LOWER LOT.
9. SURCHARGE DRAINAGE BEHIND ALL WALLS TO INCLUDE DISCHARGE PIPE INTO THE NEAREST STORMWATER STRUCTURE (OR DEDICATED KERB ADAPTOR) AND MUST BE FREE DRAINING. ALL WALL DRAINAGE LINES DISCHARGING THROUGH LOTS OR ROAD VERGE TO BE SOLID uPVC (NO SLOTS) AND MUST BE FREE DRAINING.
10. WALLS ARE TO BE CAPABLE OF SUPPORTING TWO STOREY "HEAVY CONSTRUCTION" BUILDINGS REFER TO LCC POLICY 5.
11. CONTRACTOR TO PROVIDE & MAINTAIN SAFETY FENCE TO ALL WALLS GREATER THAN 1.0m IN HEIGHT.
12. A MINIMUM 1200mm CLEARANCE IS TO BE MAINTAINED BETWEEN THE OUTSIDE OF THE BORED PIERS AND THE OUTSIDE OF ANY SEWER MAIN IN THE VICINITY OF THE RETAINING WALL.

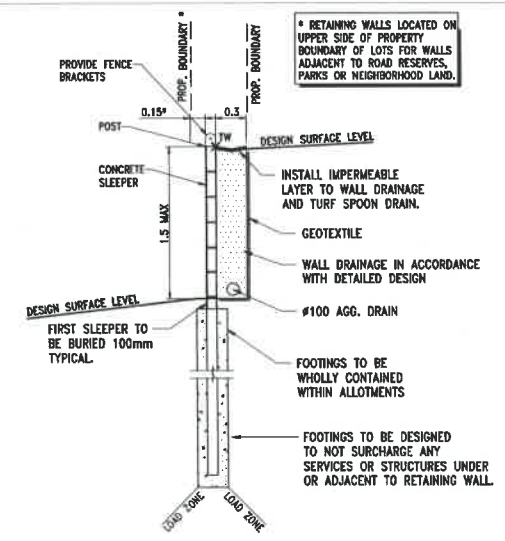
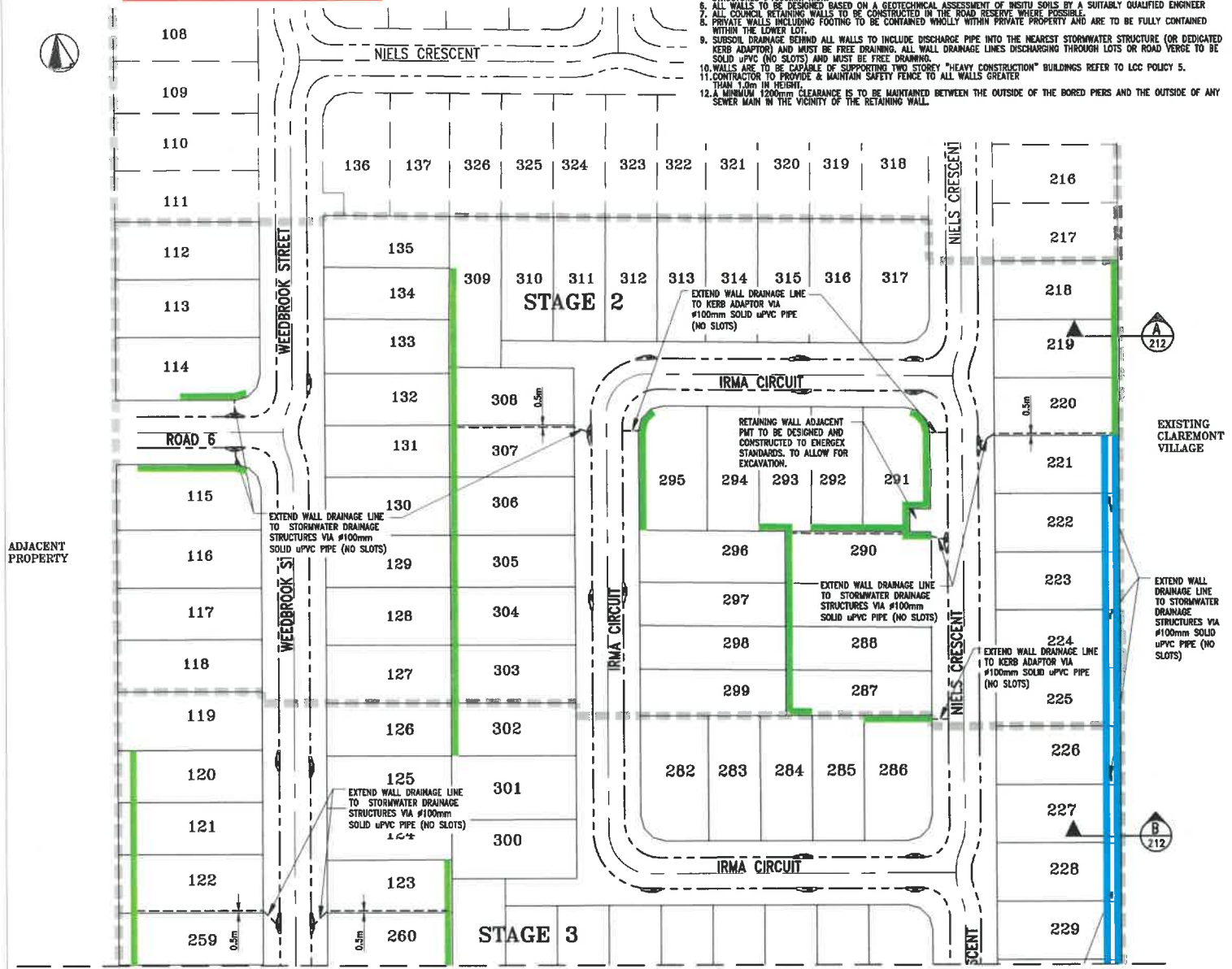

## CONCRETE SLEEPER RETAINING WALL - TYPICAL DETAIL

SCALE: NTS  
DETAILED DESIGN, SUPERVISION & CERTIFICATION TO THE SATISFACTION OF LCC IS THE RESPONSIBILITY OF THE CONTRACTOR

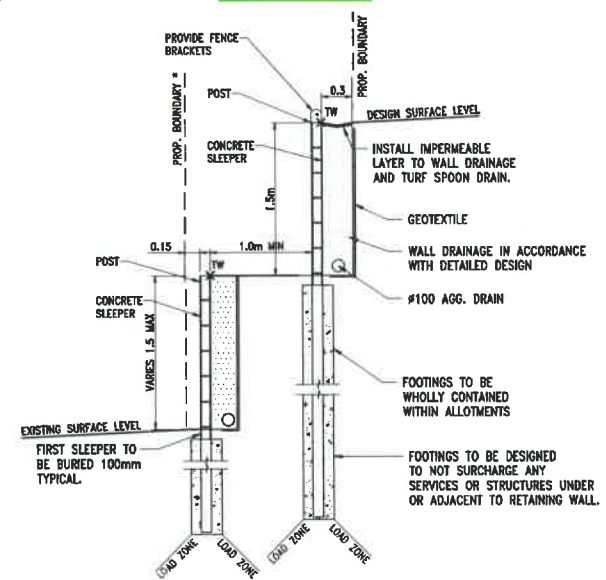

## DOUBLE TIER CONCRETE SLEEPER RETAINING WALL

SCALE: NTS  
DETAILED DESIGN, SUPERVISION & CERTIFICATION TO THE SATISFACTION OF LCC IS THE RESPONSIBILITY OF THE CONTRACTOR

REV		DESCRIPTION		BY	CHKD	DATE		SURVEYOR		JOHN HARRISON RPEO 6023		Bradlees Pty Ltd ABN 29 064 159 191		Bradlees Part of the Mowlem Group		EXIST	SOLANDER SYNDICATE LIMITED		PROJECT	409-429 PARK RIDGE ROAD PARK RIDGE - STAGES 2 & 3 LOGAN CITY COUNCIL																																																																																																																																																																																																																																																																																																																																																																																																																																																																																																																																																																																																																																																																																																																																																																																																																																																																																																																																																																																																																																													
A			ORIGINAL ISSUE	JH	AS		26.08.17			Approved by, for and on behalf of the client				Ph 07 5528 6411 Fax 07 5528 6422		www.bradlees.com.au Email mae.audrey@bradlees.com.au		TITLE	RETAINING WALL LAYOUT - SHEET 1 OF 2		STATUS	ISSUE FOR APPROVAL																																																																																																																																																																																																																																																																																																																																																																																																																																																																																																																																																																																																																																																																																																																																																																																																																																																																																																																																																																																																																																											
B			RETAINING WALL DETAIL CHANGED	JH	AS		26.08.17			This drawing has been produced for the exclusive use of the client (nominated on this document). No third party is to rely on this document without written permission from Bradlees. This drawing is not to be constructed from unless "Issued for construction" is displayed and only where signed by an RPEO.				Postal PO Box 2203, Southport QLD 4215 Gold Coast Office Level 1, 34 Thomas Drive, Chevron Island QLD 4217 Brisbane Ph 07 3018 5034 Sunshine Coast Ph 07 5461 1294							DESIGNED	AB	DRAWN	JW	APPROVED	JH	DATE	26.08.17	SCALE	1:500	BY	1	CHECKED	211	REV	C																																																																																																																																																																																																																																																																																																																																																																																																																																																																																																																																																																																																																																																																																																																																																																																																																																																																																																																																																																																																																													
C			RETAINING WALL LOCATION MODIFIED AS SHOWN	JH	AS		26.08.17			© Copyright											PROJECT NO	116460																																																																																																																																																																																																																																																																																																																																																																																																																																																																																																																																																																																																																																																																																																																																																																																																																																																																																																																																																																																																																																											
						5 0 5 10 15 20 25m																																																																																																																																																																																																																																																																																																																																																																																																																																																																																																																																																																																																																																																																																																																																																																																																																																																																																																																																																																																																																																																											