

LOGAN CITY COUNCIL
APPROVED PLAN OF DEVELOPMENT
This is the approved plan of development for Development Application
OW/42/2018

LEGEND

--- NOMINAL FACE OF KERB LINE
--- STAGE BOUNDARY

NOTES:

1. WALL ALIGNMENT IS TO BE PEGGED FOR INSPECTION BY SUPERINTENDENT PRIOR TO CONSTRUCTION.
2. WALLS TO BE VERTICAL FACE TYPE TO A MAXIMUM HEIGHT OF 1.5m. TYPE, FINISH AND COLOUR TO BE APPROVED BY SUPERINTENDENT.
3. CONTRACTOR IS RESPONSIBLE FOR PROVIDING STRUCTURAL DESIGN, CONSTRUCTION SUPERVISION AND STRUCTURAL CERTIFICATION BY A SUITABLY QUALIFIED AND EXPERIENCED REGISTERED STRUCTURAL ENGINEER (RPEO) FOR ALL WALLS 1.0m HIGH OR GREATER.
4. WALL TO BE DESIGNED FOR A MINIMUM SERVICE LIFE OF 50 YEARS.
5. THE STANDARD BUILDING REGULATION 1993 REQUIRES THAT A BUILDING APPLICATION BE LODGED FOR EARTH RETAINING STRUCTURES > 1000mm HIGH.
6. ALL WALLS TO BE DESIGNED BASED ON A GEOTECHNICAL ASSESSMENT OF INSITU SOILS BY A SUITABLY QUALIFIED ENGINEER.
7. ALL CORNER RETAINING WALLS TO BE CONSTRUCTED IN A ROAD RESERVE WHERE POSSIBLE.
8. PRIVATE WALLS INCLUDING FOOTING TO BE CONTAINED WHOLLY WITHIN PRIVATE PROPERTY AND ARE TO BE FULLY CONTAINED WITHIN THE LOWER LOT.
9. SURCHARGE DRAINAGE BEHIND ALL WALLS TO INCLUDE DISCHARGE PIPE INTO THE NEAREST STORMWATER STRUCTURE (OR DEDICATED KERB ADAPTOR) AND MUST BE FREE DRAINING. ALL WALL DRAINAGE LINES DISCHARGING THROUGH LOTS OR ROAD VERGE TO BE SOLID uPVC (NO SLOTS) AND MUST BE FREE DRAINING.
10. WALLS ARE TO BE CAPABLE OF SUPPORTING TWO STOREY "HEAVY CONSTRUCTION" BUILDINGS REFER TO LCC POLICY 5.
11. CONTRACTOR TO PROVIDE & MAINTAIN SAFETY FENCE TO ALL WALLS GREATER THAN 1.0m IN HEIGHT.
12. A MINIMUM 1200mm CLEARANCE IS TO BE MAINTAINED BETWEEN THE OUTSIDE OF THE BORED PIERS AND THE OUTSIDE OF ANY SEWER MAIN IN THE VICINITY OF THE RETAINING WALL.

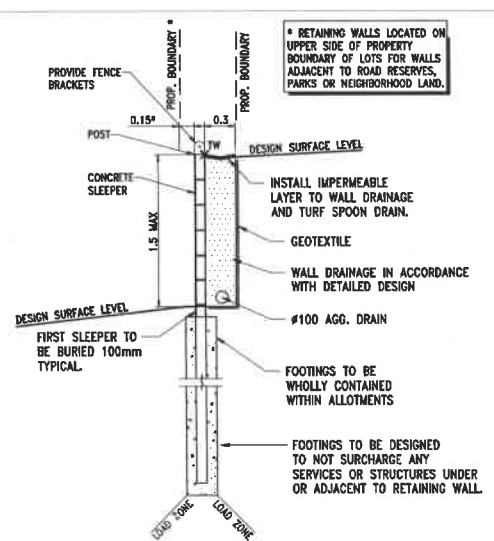
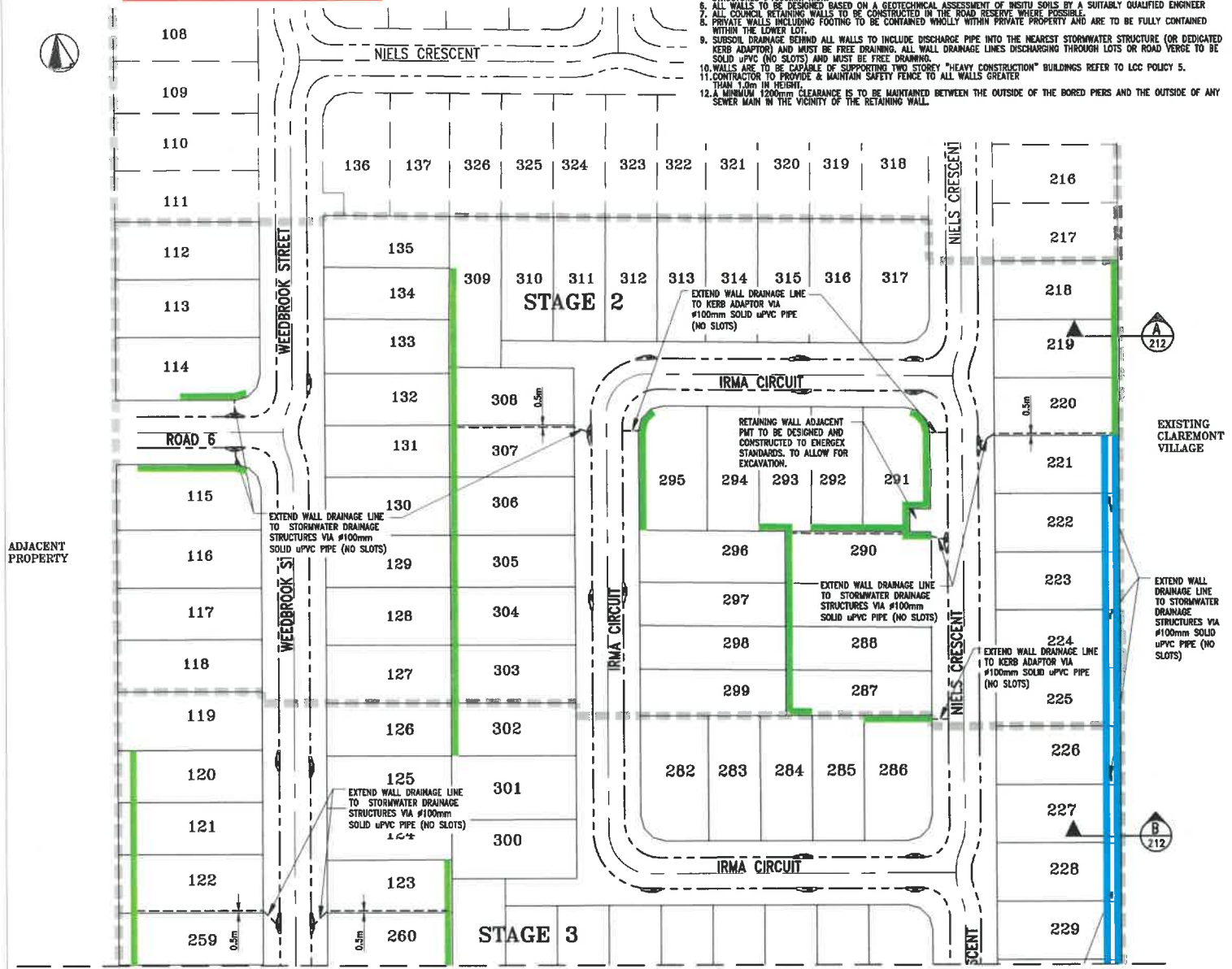

CONCRETE SLEEPER RETAINING WALL - TYPICAL DETAIL

SCALE: NTS
DETAILED DESIGN, SUPERVISION & CERTIFICATION TO THE SATISFACTION OF LCC IS THE RESPONSIBILITY OF THE CONTRACTOR

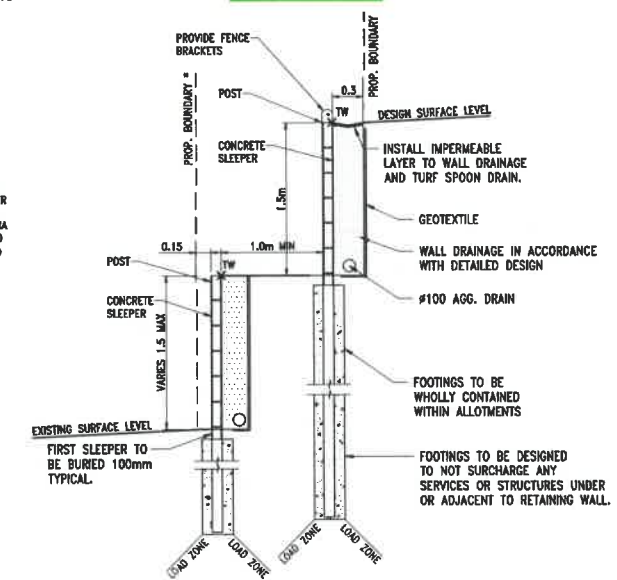

DOUBLE TIER CONCRETE SLEEPER RETAINING WALL

SCALE: NTS
DETAILED DESIGN, SUPERVISION & CERTIFICATION TO THE SATISFACTION OF LCC IS THE RESPONSIBILITY OF THE CONTRACTOR

REV		DESCRIPTION		BY	CHKD	DATE	SHEET	
A		ORIGINAL ISSUE		JH	AS	26.08.17	1	2
B		RETAINING WALL DETAIL CHANGED		JH	AS	26.08.17		
C		RETAINING WALL LOCATION MODIFIED AS SHOWN		JH	AS	26.08.17		

5

0

5

10

15

20

25m

1 : 500

(FULL SIZE A1)

1 : 1000

(REDUCED SIZE A3)

Logo

Logo

Logo

Logo

Logo

Logo

Logo

Logo

Logo

Logo

Logo

Logo

Logo

Logo

Logo

Logo

Logo

Logo

Logo

Logo

Logo

Logo

Logo

Logo

Logo

Logo

Logo

Logo

Logo

Logo

Logo

Logo

Logo

Logo

Logo

Logo

Logo

Logo

Logo

Logo

Logo

Logo

Logo

Logo

Logo

Logo

Logo

Logo

Logo

Logo

Logo

Logo

Logo

Logo

Logo

Logo

Logo

Logo

Logo

Logo

Logo

Logo

Logo

Logo

Logo

Logo

Logo

Logo

Logo

Logo

Logo

Logo

Logo

Logo

Logo

Logo

Logo

Logo

Logo

Logo

Logo

Logo

Logo

Logo

Logo

Logo

Logo

Logo

Logo

Logo

Logo

Logo

Logo

Logo

Logo

Logo

Logo

Logo

Logo

Logo

Logo

Logo

Logo

Logo

Logo

Logo

Logo

Logo

Logo

Logo

Logo

Logo

Logo

Logo

Logo

Logo

Logo

Logo

Logo

Logo

Logo

Logo

Logo

Logo

Logo

Logo

Logo

Logo

Logo

Logo

Logo

Logo

Logo

Logo

Logo

Logo

Logo

Logo

Logo

Logo

Logo

Logo

Logo

Logo

Logo

Logo

Logo

Logo

Logo

Logo

Logo

Logo

Logo

Logo

Logo

Logo

Logo

Logo

Logo

Logo

Logo

Logo

Logo

Logo

Logo

Logo

Logo

Logo

Logo

Logo

Logo

Logo

Logo

Logo

Logo

Logo

Logo

Logo

Logo

Logo

Logo

Logo

Logo

Logo

Logo

Logo

Logo

Logo

Logo

Logo

Logo

Logo

Logo

Logo

Logo

Logo

Logo

Logo

Logo

Logo

Logo

Logo

Logo

Logo

Logo

Logo

Logo

Logo

Logo

Logo

Logo

Logo

Logo

Logo

Logo

Logo

Logo

Logo

Logo

Logo

Logo

Logo

Logo

Logo

Logo

Logo

Logo

Logo

Logo

Logo

Logo

Logo

Logo

Logo

Logo

Logo

Logo

Logo

Logo

Logo

Logo

Logo

Logo

Logo

Logo

Logo

Logo

Logo

Logo

Logo

Logo

Logo

Logo

Logo

Logo

Logo

Logo

Logo

Logo

Logo

Logo

Logo

Logo

Logo

Logo

Logo

Logo

Logo

Logo

Logo

Logo

Logo

Logo

Logo

Logo

Logo

Logo

Logo

Logo

Logo

Logo

Logo

Logo

Logo

Logo

Logo

Logo

Logo

Logo

Logo

Logo

Logo

Logo

Logo

Logo

Logo

Logo

Logo

Logo

Logo

Logo

Logo

Logo

Logo

Logo

Logo

Logo

Logo

Logo

Logo

Logo

Logo

Logo

Logo

Logo

Logo

Logo

Logo

Logo

Logo

Logo

Logo

Logo

Logo

Logo

Logo

Logo

Logo

Logo

Logo

Logo

Logo

Logo

Logo

Logo

Logo

Logo

Logo

Logo

Logo

Logo

Logo

Logo

Logo

Logo

Logo

Logo

Logo

Logo

Logo

Logo

Logo

Logo

Logo

Logo

Logo

Logo

Logo

Logo

Logo

Logo

Logo

Logo

Logo

Logo

Logo

Logo

Logo

Logo

Logo

Logo

Logo

Logo

Logo

Logo

Logo

Logo

Logo

Logo

Logo

Logo

Logo

Logo

Logo

Logo

Logo

Logo

Logo

Logo

Logo

Logo

Logo

Logo

Logo

Logo

Logo

Logo

Logo

Logo

Logo

Logo

Logo

Logo

Logo

Logo

Logo

Logo

Logo

Logo

Logo

Logo

Logo

Logo

Logo

Logo

Logo

Logo

Logo

Logo

Logo

Logo

Logo

Logo

Logo

Logo

Logo

Logo

Logo

Logo

Logo

Logo

Logo

Logo

Logo

Logo

Logo

Logo

Logo

Logo

Logo

Logo

Logo

Logo

Logo

Logo

Logo

Logo

Logo

Logo

Logo

Logo

Logo

Logo

Logo

Logo

Logo

Logo

Logo

Logo

Logo

Logo

Logo

Logo

Logo

Logo

Logo

Logo

Logo

Logo

Logo

Logo

Logo

Logo

Logo

Logo

Logo

Logo

Logo

Logo

Logo

Logo

Logo

Logo

Logo

Logo

Logo

Logo

Logo

Logo

Logo

Logo

Logo

Logo

Logo

Logo

Logo

Logo

Logo

Logo

Logo

Logo

Logo

Logo

Logo

Logo

Logo

Logo

Logo

Logo

Logo

Logo

Logo

Logo

Logo

Logo

Logo

Logo

Logo

Logo

Logo

Logo

Logo

Logo

Logo

Logo

Logo

Logo

Logo

Logo

Logo

Logo

Logo

Logo

Logo

Logo

Logo

Logo

Logo

Logo

Logo

Logo

Logo

Logo

Logo

Logo

Logo

Logo

Logo

Logo

Logo

Logo

Logo

Logo

Logo

Logo

Logo

Logo

Logo

Logo

Logo

Logo

Logo

Logo

Logo

Logo

Logo

Logo

Logo

Logo

Logo

Logo

Logo

Logo

Logo

Logo

Logo

Logo

Logo

Logo

Logo

Logo

Logo

Logo

Logo

Logo

Logo

Logo

Logo

Logo

Logo

Logo

Logo

Logo

Logo

Logo

Logo

Logo

Logo

Logo

Logo

Logo

Logo

Logo

Logo

Logo

Logo

Logo

Logo

Logo

Logo

Logo

Logo

Logo

Logo

Logo

Logo

Logo

Logo

Logo

Logo

Logo

Logo

Logo

Logo

Logo

Logo

Logo

Logo

Logo

Logo

Logo

Logo

Logo

